

LOCAL DEVELOPMENT PLAN

LOT 27 WESTFIELD ROAD, CAMILLO (CITY OF ARMADALE)

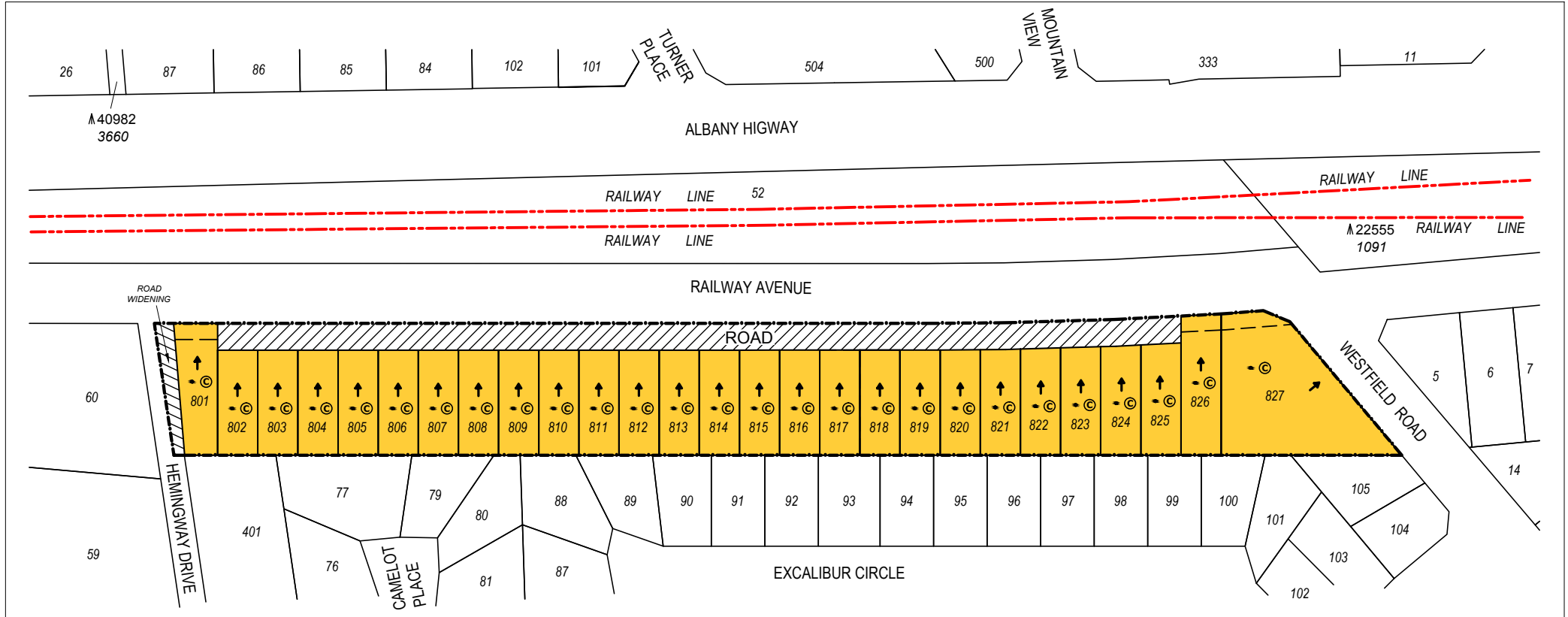

LOCAL DEVELOPMENT PLAN PROVISIONS:

This Local Development Plan (LDP) has been prepared pursuant to Clause 52(1)(a) of the Planning and Development (Local Planning Schemes) Regulations 2015 - Schedule 2 - Deemed Provisions and the Residential Design Codes

Quiet House Design:

- 1) Dwellings on lots identified as requiring "Quiet House Design" are to be constructed in accordance with the relevant "Deemed to Comply Noise Treatment Package" specified on this LDP. Further guidance on Acceptable Noise Treatment Package requirements can be found in the approved acoustic assessment (Lloyd George Acoustics - Appendix A - quiet house design C)
- 2) At least one outdoor living area is to be shielded from the transport corridor.

Approval:

Pursuant to Clause 52(1)(1) of the Planning and Development (Local Planning Schemes) Regulations - 2015 Schedule 2 - Deemed Provisions this Local Development Plan is hereby approved.

Authorised Officer:

Date: 08/04/2020

SCALE 1:1500 @ A3

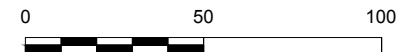

ALL DISTANCES ARE IN METRES

LEGEND

- EXTENT OF LOCAL DEVELOPMENT PLAN
- LOTS REQUIRING NOTIFICATION ON TITLE IN REGARDS TO TRANSPORT NOISE
- LOT ORIENTATION
- QUIET HOUSE DESIGN (IMPLEMENTATION GUIDELINES SPP 5.4 - PACKAGE C) FOR BOTH SINGLE AND TWO STOREY BUILDINGS.
- NO HABITABLE PORTION OF BUILDING WITHIN 6 METRES OF FRONT BOUNDARY.
- PROPOSED ROAD
- PROPOSED ROAD WIDENING



THE LAND DIVISION
PLANNING | SURVEYING | DESIGN

PO BOX 2444, MALAGA, WA 6090
T: 9209 3232 | F: 9249 2551
E: INFO@LANDDIVISION.COM.AU

JOB NUMBER: 20-8697 DRAFTING DATE: 4-03-2020